

Navis Consult

a KONGSBERG company

COMPANY PRESENTATION

12/11/2021

PROFILE

1996	Company founded
2000 - 2019	Part of Rolls-Royce Marine group (as a Joint Venture company owned 75% by RR) mainly providing engineering services for RRM ship design projects for offshore vessels market
2019 – June 2021	Part of KONGSBERG (as a Joint Venture company owned 75% by KM) supporting KM business units with engineering and also providing engineering services to the shipbuilding market worldwide.
June 2021	Fully owned by KONGSBERG

Strong competence in engineering of complex ship types for different shipbuilding technologies and management of large volume engineering in a dynamic multi-project environment.

ANNUAL ENGINEERING CAPACITY
ABOVE 350.000 HRS

ENGINEERING DELIVERED TO
MORE THAN 60 SHIPYARDS
WORLDWIDE

LOCATIONS



Head office : Rijeka



Branch office : Pula

MAIN ACTIVITY SEGMENTS

ENGINEERING SERVICES FOR SHIPBUILDING INDUSTRY

- Basic design, detail and production engineering for newbuildings and conversions – all disciplines:
 - Structure
 - Hull outfitting
 - Interior
 - Piping and HVAC
 - Electrical



ENGINEERING SUPPORT FOR KONGSBERG

ENGINEERING FOR KM SHIP DESIGN

Basic and Detail Design support for all UT and NVC design projects



SYSTEM INTEGRATION ENGINEERING FOR KM SYSTEMS

Electrical system engineering for KM systems

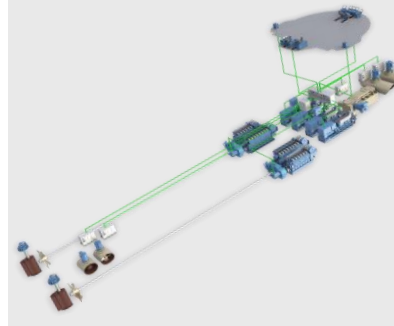

ENGINEERING FOR KM PRODUCTS

- Power electric system products
- Automation and Control products
- Propulsion products
- Rudders and Steering Gears
- Deck Machinery products



SCOPE OF SHIP DESIGN & ENGINEERING SERVICES

TYPE OF SERVICE	TOOLS
Basic Design / Classification drawings and calculations for structure, hull outfitting, machinery and electrical systems	Autocad, Napa, Napa Steel, Rule scantling programs, FEM
Detail Engineering and production drawings for structure , outfitting, piping, HVAC, interior, cable trays	Foran , Aveva Marine (E3D) / Tribon, Cadmatic, ShipConstructor
Electrical detail engineering – complete scope from basic design , system integration to cable routing and connections	Autocad, Cable routing database program

SELECTED ENGINEERING SERVICES

Design and Class documentation – structure, outfitting, machinery and electrical

Layouts and Arrangements, Safety

Structural calculations – strength, vibrations

Hydrostatic and Stability calculations, Inclining tests, Stability Manuals, Weight follow-up

Ship manuals

Technical procurement support – specifications and Vendor's offers evaluations

Site support in shipyards

3D product modelling for structure and outfitting in Aveva, Foran, SC, Cadmatic

Production and installation documentation for structure, piping, ventilation and cable trays

HVAC concept layouts and detail arrangements

Interior layouts and detail design

Electrical cable booklets, installation plans, cable trays, connection diagrams

ENGINEERING SOFTWARE

Ship design & engineering :



FORAN



General / mechanical :



AutoCAD

Electrical :



Navis Consult

a KONGSBERG company

FULL 3D MODEL BASED ENGINEERING

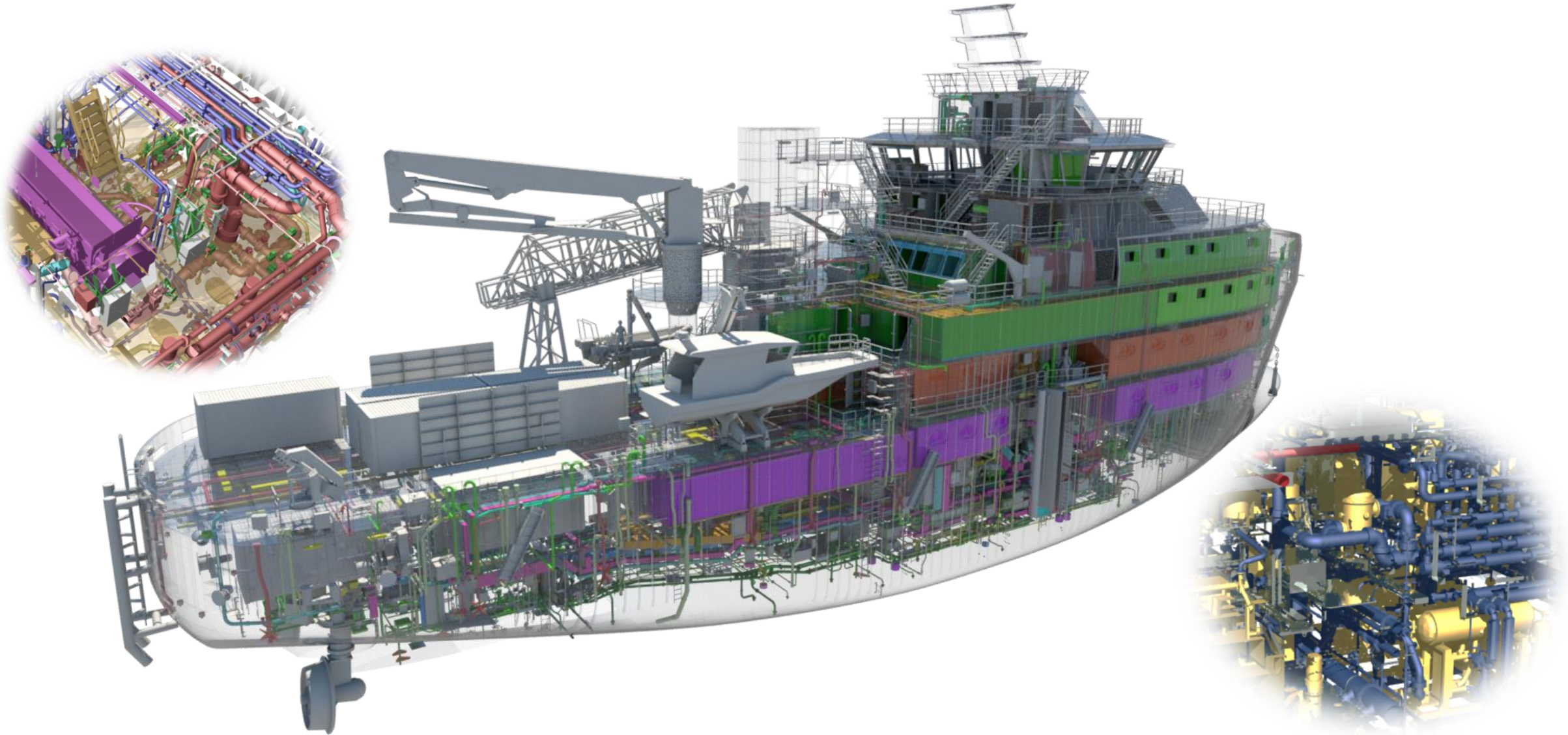

FULL 3D MODEL BASED ENGINEERING

3D model picture of actual Trawler project for USA shipyard

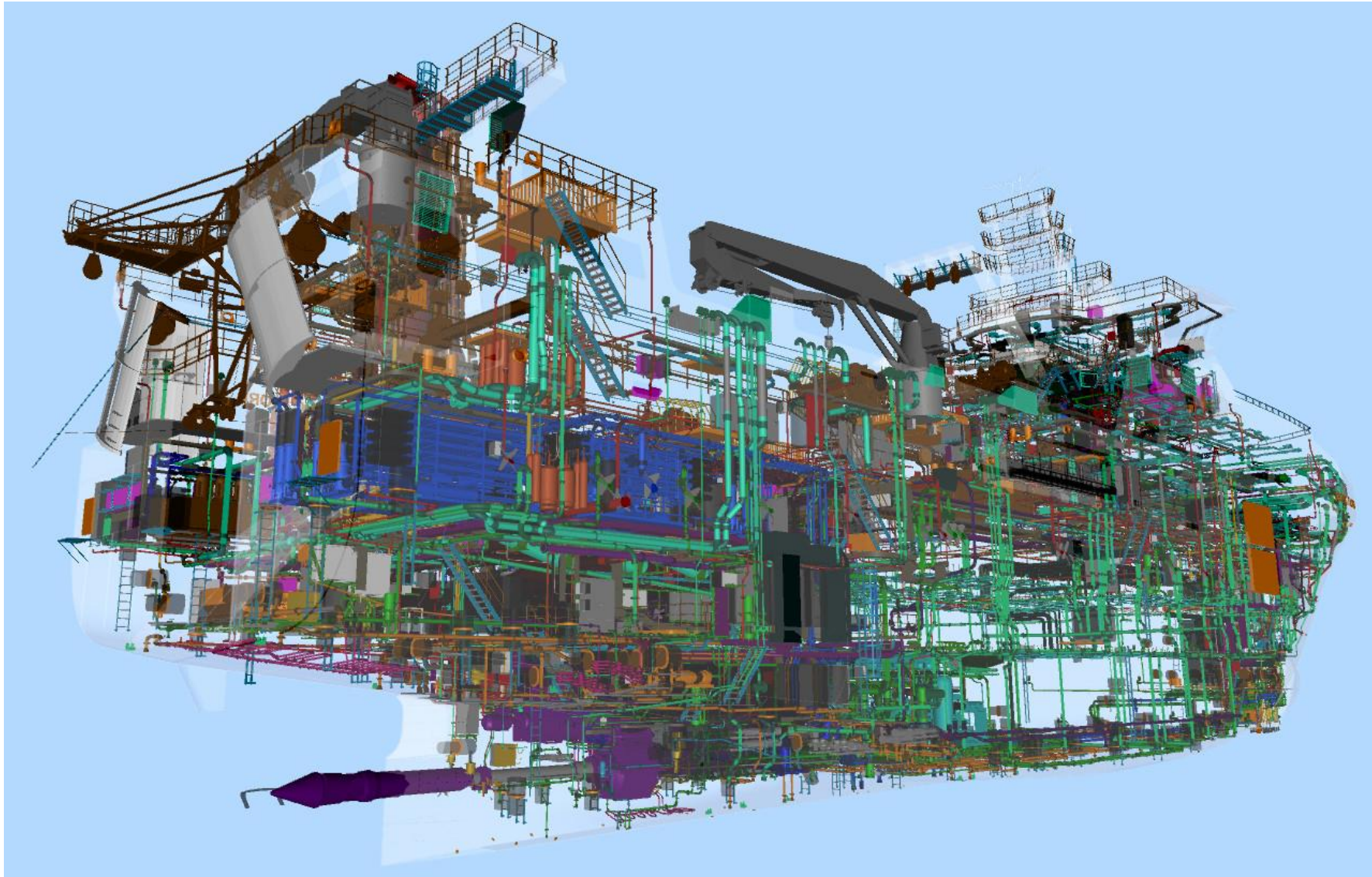

FULL 3D MODEL BASED ENGINEERING (cont.)

3D model picture of Trawler project for Norwegian shipyard

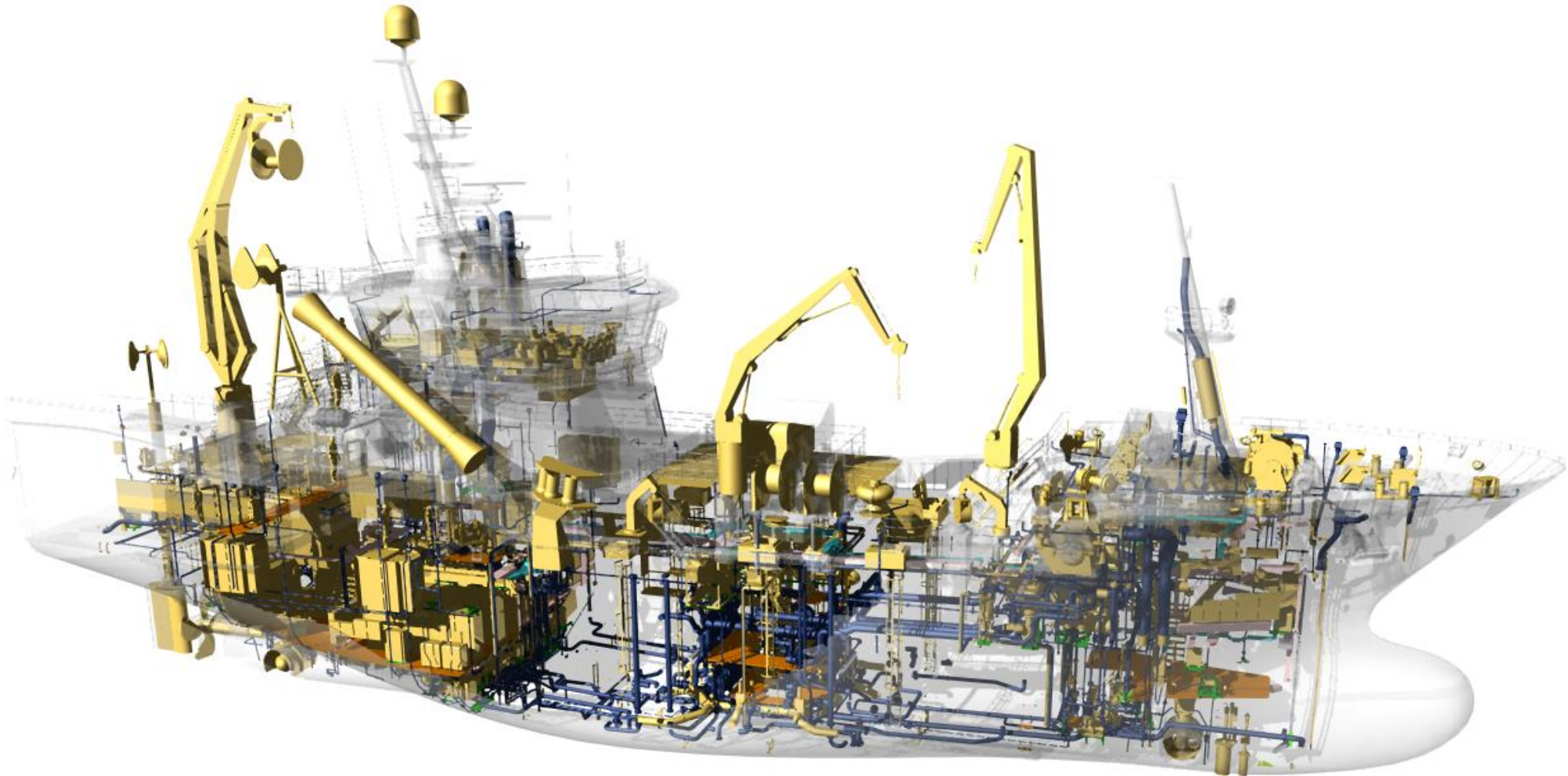

FULL 3D MODEL BASED ENGINEERING (cont.)

3D model picture of Polar Cruiser project for Norwegian shipyard

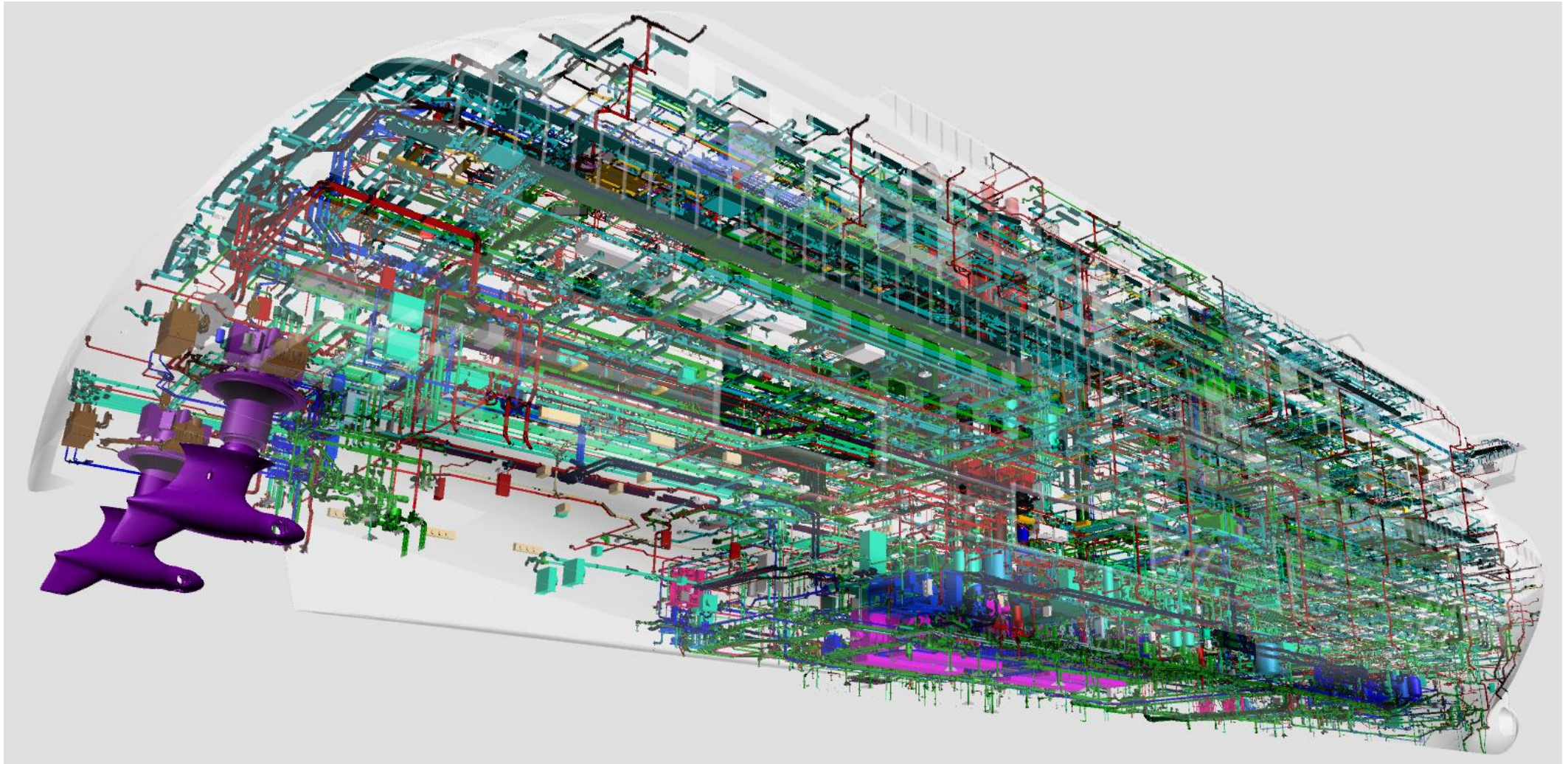

REFERENCE LIST OF SHIPYARDS

Croatia:	Viktor Lenac, Brodosplit, 3.Maj, Brodotrogir, Dalmont
Norway:	Vard, Kleven, Havyard, Myklebust, Fjellstrand, Larsen, Palmer Johnson, Vagland, Westcon
Italy:	Rosetti Marino, NCA, Fincantieri
Spain:	Zamakona, Gondan, Freire, Armon
Poland:	Remontowa, Maritime Shipyard
Finland:	Meyer Turku, RMC, Helsinki Shipyard
Germany:	Kusch, Fassmer
UK:	Cammell Laird, BAES
Denmark:	Karstensen
Turkey:	Tersan, Besiktas, Eregli
Brazil:	Wilson&Sons, EISA, Alianza, Brasfels, Itajai, Sao Miguel
Chile:	Asenav, Asmar
China:	Shanghai, Mawei, Tsuji, COSCO, Wuchang, Fujian SouthEast, Synopacific
India:	ABG, Cochin, Bharati,
Korea:	Sekwang, Hyundai MIPO,
Malaysia:	Nam Cheong
Indonesia:	DDW Nanindah
Singapore:	DDW Singapore, Keppel, Pax Ocean
Canada:	Halifax, Davie
USA:	BAES, ThomaSea, Fincantieri Bay Shipyard, Vigor
Japan:	Kawasaki
Saudi Arabia:	Zamil

WORLDWIDE FOOTPRINT OF OUR DETAIL ENGINEERING DELIVERIES



REFERENCES – Offshore Vessels



REFERENCES – COASTGUARD / NAVY



Indian Coast Guard vessel –
complete engineering



Danish Fishery Patrol vessel –
complete engineering



Patrol vessel for German Police – Machinery Basic
Design and Detail Engineering Outfitting



Iceland Coast Guard vessel –
complete engineering



AOR vessel (conversion from cargo ship)
Full scope design and detail engineering

REFERENCES – Merchant vessels



LNG cargo vessel – complete detail engineering



Paper carrier – complete detail engineering



Arctic tanker- detail engineering cargo area



LNG cargo vessel – complete detail engineering



Stainless steel chemical tanker – complete detail engineering

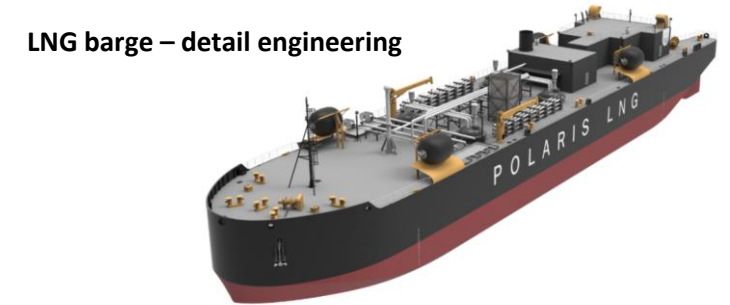

LNG barge – detail engineering



Bulk carrier – detail engineering

REFERENCES – Fishing vessels



REFERENCES – Conversions



M/S Lochanagar – Conversion PSV to pipelayer
Engineering and production information - all disciplines

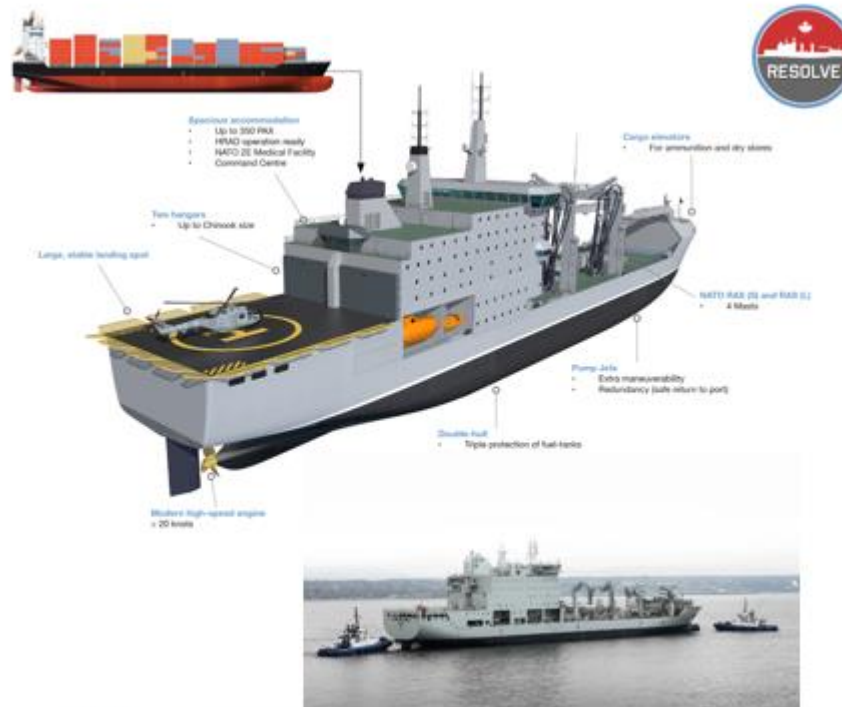

M/V Asterix - Complete design and detail engineering



M/V Samson : Conversion to pipe layer, full detail engineering scope



M/S Komandor 3000 – Conversion cargo ship to pipe layer – complete engineering and site support



M/V Cable Enterprise : Conversion to DP2, full basic design and detail engineering scope

REFERENCES – Yachts / Cruise / Ro-Pax

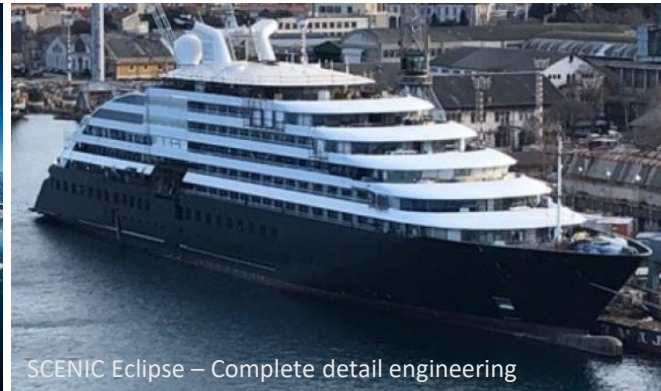

Navis Consult

a KONGSBERG company

Bartola Kasica 5/4
HR-51000 RIJEKA, CROATIA
Tel. +385 51 500 100
navis@km.kongsberg.com